

SRIVIJAYA VISAKHA MILK PRODUCERS COMPANY LIMITED

CIN :UI5209AP2006PTC048708

An ISO 9001 & 22000 Certified Dairy

Regd.No.48708/05-06, (Visakha Dairy, Visakhapatnam -530012)

Lr.No.07/AGM(C&P)/BCC/Tadikilapudi/2022/(V-1)

Dt.25/01/2023.

To,

Sir/ Gentleman,

Sub:-C&P Wing- Visakha Dairy- Visakhapatnam – Construction of Bulk Milk Cooling Center (Ground floor) at TADIKILAPUDI Village, Kamavarapukota Mandal in Eluru District - Quotations - Reg.

@ @ @

You are requested to quote your lowest price for Construction of Bulk Milk Cooling Center (Ground floor) at TADIKILAPUDI Village, Kamavarapukota Mandal in Eluru District including Building materials and labour charges for the works mentioned (Annexure enclosed).

The Quotations should be addressed to the Managing Director, Sri Vijaya Visakha Milk Producers Company Limited, Opp. BHPV, Visakhapatnam-530012 and the same should reach this office on or before 31/01/2023 by 3.00 P.M.

Encl:-

- 1) Specification Annexure.
- 2) Drawings.

Yours faithfully,

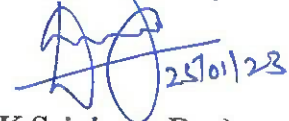
 25/01/23

(K.Srinivasa Rao)

Asst.General Manger,

Civil & Projects.

Contact No.9963553888.

ANNEXURE

**N.W:- Construction of Bulk Milk Cooling Center with RCC roofing at TADIKILAPUDI (V),
KAMAVARAPUKOTA (M), ELURU District.**

S.No	Description of work	Qty	Per	Rate	Per	Amount
1	Providing Anti termite treatment with chloripyriphos 20% EC/Lindane -20% EC with a hand operator pressure pump at applicable areas, the plinth area of the building for Various stages i.e. 1st stage of treatment at Builidng foundation level, 2nd stage of treatment at basement level and 3rd stage at over all building completion all costs & conveyances for finished item of work. (For 3 Stages) Payment will be made after completion of total work.	1,080.00	Sft		Sft	
2	Earthwork Excavation in any type of gravelly soils except rock requiring blasting in all conditions such as dry, wet and slushy & depositing the soils including all incidental and operational charges etc., complete. including bailing of water	75.00	Cum		Cum	
3	Supplying and filling of Earth trench with Crusher dust filling in foundation conforming to standard specifications including cost and conveyance of all materials, labour charges, ramming, consolidation throughly.	4.15	Cum		Cum	
4	C.C.(1:6:10) Prop. using 40mm gauge HBG metal of approved quality including cost and conveyance of all materials, labour charges, machine mixing, curing etc., complete. Excluding cost of Cement.	9.00	Cum		Cum	
5	R.R. Masonary in C.M(1:6) Prop. using rough stones of approved quality including cost and conveyance of all materials, labour charges, curing, providing Bond stones. Excluding cost of Cement.	27.00	Cum		Cum	
6	R.C.C(1:1.1/2:3) Prop. using 20mm gauge HBG graded metal Machine crushed of approved quality including cost and conveyance of all materials, labour charges, machine mixing, vibrating, finishing and curing, centering charges etc., complete. But excluding the cost of steel reinforcement of work & its fabrication charges which will be accounted separately for the following items of works. Excluding cost of Cement.					
a	Columns Pedastals	9.00	Cum		Cum	
b	Columns	9.00	Cum		Cum	

S.No	Description of work	Qty	Per	Rate	Per	Amount
c	Plinth beam	7.00	Cum		Cum	
d	Raft slab	5.00	Cum		Cum	
e	Lintel beam	1.50	Cum		Cum	
f	Sunshades	1.00	Cum		Cum	
g	Roof beams	5.00	Cum		Cum	
h	Roof Slab	17.00	Cum		Cum	
7	Cutting, Bending and Fabrication of bars & Placing them in position of all sizes on MS ribbed bars & for all items of RCC works at all heights including cost and conveyance of Binding wire, labour charges etc., complete, Excluding cost of Steel.	5.00	MT		MT	
8	Refilling with excavated earth in column pits all labour charges, ramming, consolidation etc., complete.	30.00	Cum		Cum	
9	Supplying and filling of Gravel in basement conforming to standard specifications including cost and conveyance of all materials, labour charges, ramming, consolidation etc., complete.	100.00	Cum		Cum	
10	C.C.(1:4:8) Prop. using 40mm gauge HBG metal of approved quality including cost and conveyance of all materials, labour charges, machine mixing, curing etc., complete. Excluding cost of Cement.	14.00	Cum		Cum	
11	Brick Masonary in C.M(1:6) Prop. using 1st class Country Bricks of approved quality from masonary for walls of all thickness including cost and conveyance of all materials, labour charges, curing, racking the joints, scaffolding charges etc., complete. Excluding cost of Cement.	33.00	Cum		Cum	
12	Plastering in C.M(1:4) Prop. 3/4" thick in Single coat with smooth finishing including cost and conveyance of all materials, labour charges, curing, Scaffolding charges etc., complete. for all walls inside & outsides. Excluding cost of Cement.	450.00	Sqmt		Sqmt	
13	Ceiling Plastering in C.M(1:3) Prop. 1/2" thick in Single coat with smooth finishing including cost and conveyance of all materials, labour charges, curing, Scaffolding charges etc., complete. for all ceilings inside & outsides. Excluding cost of Cement.	130.00	Sqmt		Sqmt	

S.No	Description of work	Qty	Per	Rate	Per	Amount
14	Providing of Kota stone flooring with 23"x23" size and 1" thick Pure cement over a base coat of CM(1:4) 3/4" thick including cost of all materials, labour charges for fixing, transportation charges and all charges for cutting & polishing the laid floor to get a neat & clean surface etc., complete. Excluding cost of Cement.	50.00	Sqmt		Sqmt	
15	Ceramic tiles for floor / Glazed tiles for walls of size 8"x12"/12"x 12" of 1/4" thick Pure cement over a base coat of CM(1:4) 3/4" thick including cost and conveyance of all materials labour charges all incidental and operational charges etc., complete. Laying proper slope and direction complete. Excluding cost of Cement. (Basic rate of 40/-sft)	40.00	Sqmt		Sqmt	
16	Granolithic flooring 1" thick with CC(1:1:2)prop. Using crushed granite chips of size 6mm to 10mm including cost and conveyance of all materials, labour charges curing incidental and operational charges etc, complete.Excluding cost of Cement.	15.00	Sqmt		Sqmt	
17	Supplying and fixing in position of Powder coated Alluminium two track sliding window shutters (Zindal or Indal variety), 61.85 X 31.75 X 1.5mm two track box Section, top & side. 61.85 X 31.75 X 1.5mm box section, Shutter 40 X 20 X 1.5mm section with button locks, Handles, Bearings (TPI) etc., 4mm plain glass of modiguard/Saint gobin company with necessary Hardware including 4mm pvc clear beading etc, complete.	9.50	Sqmt		Sqmt	
18	Supplying & Fixing of Aluminium Door with Powder coated section alround 101x44.45x2mm, verticals with 85x44.45x2mm, top & centre 95x44.45x2mm thick, and Bottom 85x44.45x2mm with Bottom 12mm thick WPC panel Sheet and 5mm thick plain glass saint gobain, including necessary clips, Screws, Clamps, Rubber beeding, Glass putty, Tower bolts, Handles, Hinges, 2 sets of Lock & Keys, wooden track sleeves etc, complete.	2.25	Sqmt		Sqmt	

S.No	Description of work	Qty	Per	Rate	Per	Amount
19	Manufacturing, Supplying and fixing of Rolling Shutters of required size made out of guaranteed 19 gauge X 3mm thick mild steel lathes of convex corrugation type of 1/8" thick plates with interlocking arrangements of steel lathes by means of new pipes load with high tensile coils type spring made of strong continental pulling hooks, handles with all fittings accessories in best workmanship including top cover the same gauge, the entire shutter and cover is to be painted with one thick coat of redoxide paint. The payment will be made for only clear openings.	12.00	Sqmt		Sqmt	
20	Painting two coats with Birla White cement paint after cleaning the surface perfectly well cost includes cost and conveyance of all materials, labour charges, cost of Brushes etc., complete.	560.00	Sqmt		Sqmt	
21	Painting to new Wood work or Iron work with two coats of first class synthetic Enamel paint of approved make and colour and quality over a primary coat (1 Coat of Primer) after the surface is perfectly cleaned to all heights including cost and conveyance of all materials, labour charges, scaffolding charges,all incidental and operational charges, cost of Brushes, cleaning the debris etc., complete. (total 3 coats)	60.00	Sqmt		Sqmt	
22	Painting with Interior emulsion paint with Two coats of approved colour and quality by using 1st quality two coats paint over a primary coat (1 Coat of Primer) after cleaning the surface perfectly well and painting it neatly and carefully finished including cost and conveyance of all materials, labour charges, scaffolding charges etc, complete. (total 3 coats)	350.00	Sqmt		Sqmt	
23	Painting with Exterior emulsion paint with Two coats of approved colour and quality by using 1st quality two coats paint over a primary coat (1 Coat of Primer) after cleaning the surface perfectly well and painting it neatly and carefully finished including cost and conveyance of all materials, labour charges, scaffolding charges etc, complete. . (total 3 coats)	250.00	Sqmt		Sqmt	
24	Manufacturing, supplying and fixing of MS Grills of approved design of size 12mm square MS bars, 100mm c/c 30x30x6mm MS Angular around frame for Compressor grills/ Window grills including cost and conveyance of all materials and fabrication charges etc, complete.	26.00	Sqmt		Sqmt	

S.No	Description of work	Qty	Per	Rate	Per	Amount
25	Supplying and fixing of M.S.Angle of size 65x65x6mm	75.00	Kgs		Kg	
26	Grading Plastering over the roof slab with CM(1:3) prop. 1" thick mixed with water proofing compound to IS-2645 (CICO)/ approved equivalent of approved make @ 2% by weight of cement and giving smooth finishing with pure cement @0.75 Cft. for 100 sft. of area including cost and conveyance of all materials, labour charges, curing etc., complete. Excluding cost of Cement.	120.00	Sqmt		Sqmt	
					Rs	_____
27	Cost of Cement OPC 53 Grade (PRIYA/ ULTRATECH)	758.00	Bag		Bag	
28	Cost of Steel (VSP/SAIL)	5.00	MT		MT	
					Rs	_____ _____

SIGNATURE OF THE CONTRACTOR

Note: - I Agree that Management has right either to accept / reject the tenders without ascertaining any reasons.

CONSTRUCTION OF NEW BMCC AT TADIKALAPUDI, ELURU DISTRICT

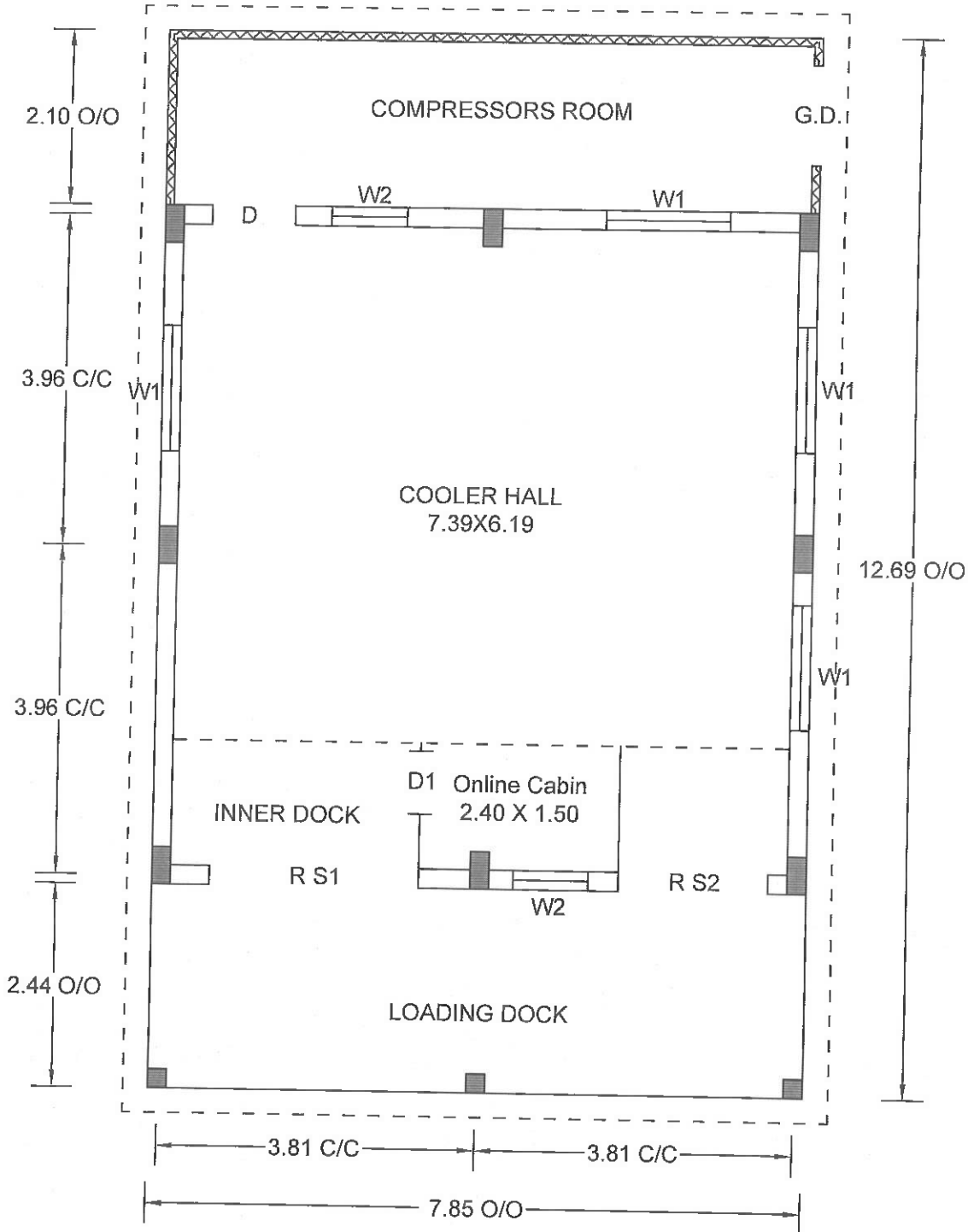
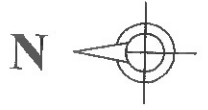

GROUND FLOOR PLAN